



# *smart* STARPEN

Skin Care Device [Auto MTS]

STARPEN delivers active ingredients to the epidermal layer of the skin through a passage made of microneedles, maximizing absorption and helping with skin regeneration.

---

# WHY YOU NEED *Starpen*

Microneedling (MTS) enhances skin regeneration by creating micro-injuries that trigger collagen production, improving multiple skin concerns.



Oily Complexion

Dryness

Acne

Clogged Pores

Wrinkle

Dullness

Pigmentation

Redness

# MTS

*Micro-needle Therapy System*

How much of the active ingredients in cosmetics are actually absorbed?

When using MTS, the absorption rate of general cosmetics is around 0.4%,

**increasing by more than 100 times**

compared to applying it in a general way.

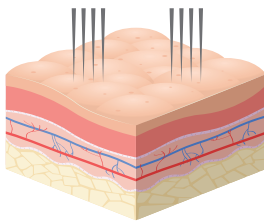
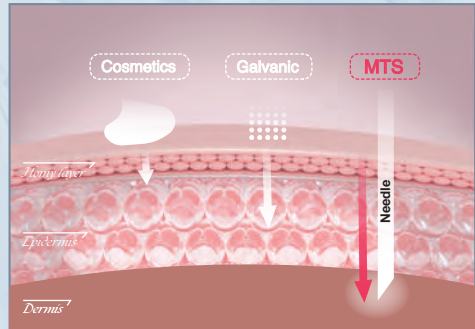

*Skin Barrier*

Epidermis  
Dermis  
Hypodermis

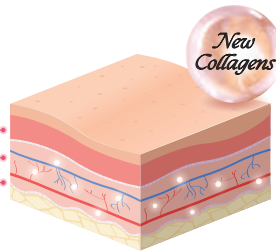

Microneedling creates channels stimulating natural healing.



Fibroblasts generate new collagens to make firm and smooth skin.

## Needle

\*Needles are not included.



**Needle 42**

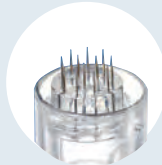

**Needle 12**



**Nano Needle**



## *Effects*



Pore  
Tightening



Brightening



Anti-aging  
(Wrinkle Care)



Acne  
Treatment



Moisturizing



Skin Tone  
Improvement

# How to use

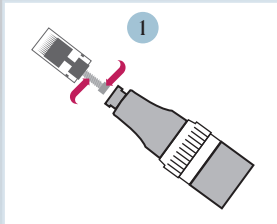

Open the needle cartridge and attach it to the main body counterclockwise.

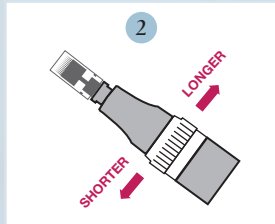

Adjust the needle length by rotating the adjustment ring.

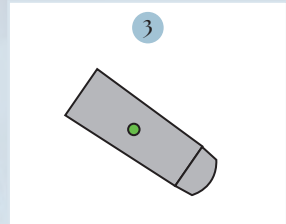

Operate STARPEN with the on/off switch and set the speed in 6 steps.

## STARPEN *Tip* Management

- ✓ Check for allergic reactions.
- ✓ Needles are single-use only, please replace them after each use.
- ✓ Hold the device lightly and stamp it in a small circle from the inside of your face to the outside.
- ✓ The faster the stamping speed, the faster the movement; the slower the stamping speed, the slower the movement.



## Components

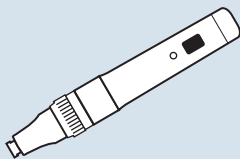

Starpen

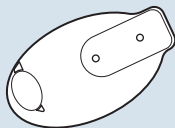

Stand

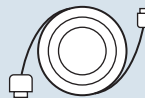

Cable



Adapter



# Q&A

## Q. Would it be painful?

**A.** If you're using MTS for the first time, it's best to start with short, fine needles. This way, it won't hurt, and it's easier to use. For beginners, it's recommended to use a 0.1mm needle or a nano-needle.

Since everyone's skin thickness is different, you can start with a shorter needle and gradually increase the length to find the one that works best for your skin.

However, for home use, it's recommended that the needle length not exceed 0.25mm.

## Q. How often can I use STARPEN?

**A.** It is recommended to use it at 7-10 days intervals.  
(2 weeks interval for sensitive skin type)

## Q. Are needles reusable?

**A.** MTS needles are disposable.  
Please replace the needle immediately after using it.

### STARPHARMTEC INC.

Office 2F, J bldg, 271-6, Dapsimni-ro, Dongdaemun-gu, Seoul, Republic of Korea

Tel | Whatsapp +82 10 7341 3026(ENG), +82 10 6891 3026(SPANISH)

Email sales@starpharmtec.com Website www.starpharmtec.com Instagram @starpharmtec\_global